

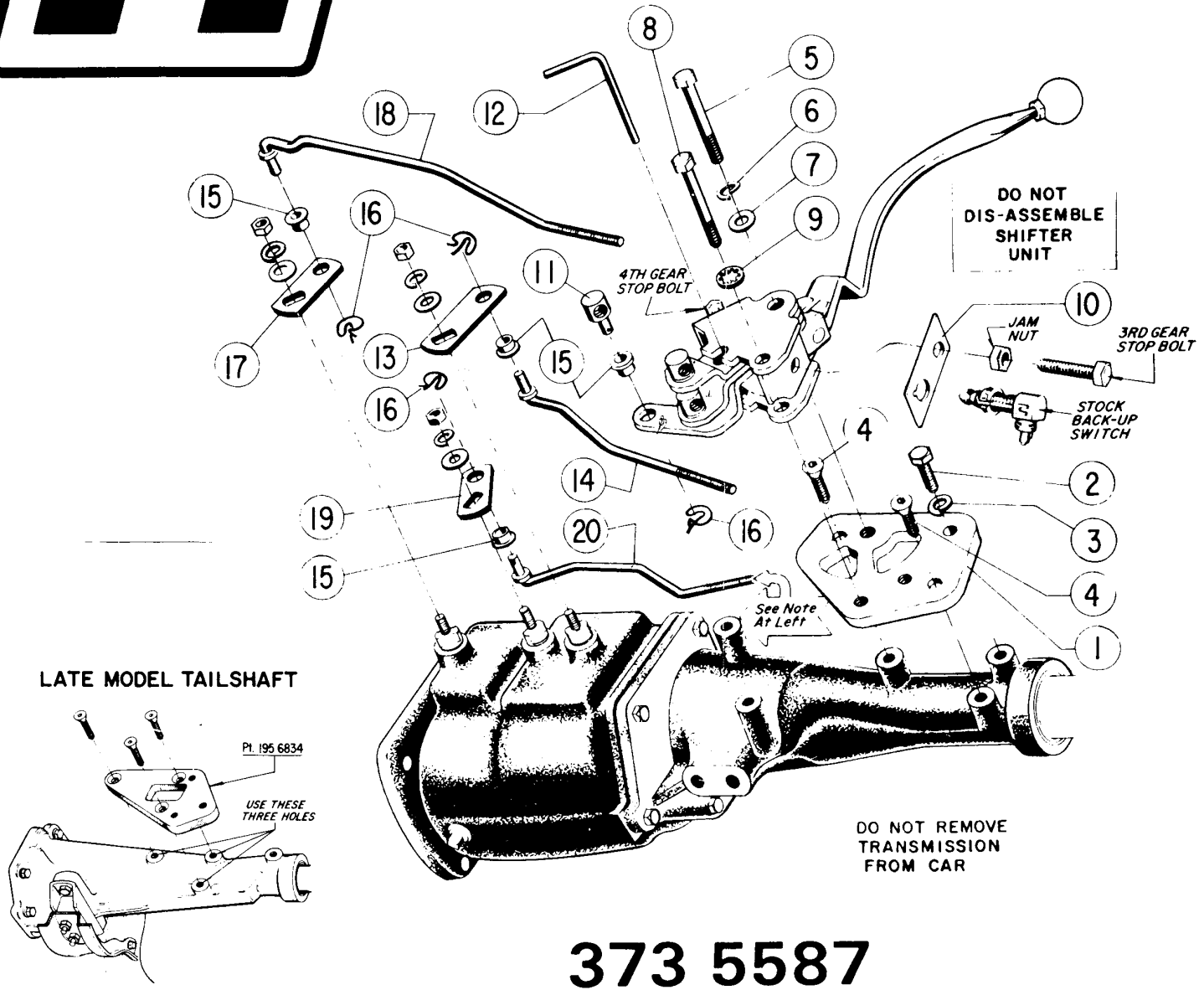

COMPETITION/PLUS®

U.S. PATENT NO. 3.216.274 & NO. 3.306.126



373 5587

CONTENTS OF KIT

373 3185

- | | |
|---------------------------------------|------------------|
| 1. MOUNTING PLATE | Pt. 195 3176 |
| 2. 5/16 - 18 x 1 HEX HD. CAP SCREW | |
| 3. 5/16" SPLIT LOCKWASHER | |
| 4. 5/16 - 18 x 1 FLAT HD. SOCKET | |
| 5. 7/16 - 14 x 3 HEX HD. CAP SCREW | |
| 6. 7/16" SPLIT LOCKWASHER | |
| 7. 7/16" FLATWASHER | |
| 8. 3/8 - 16 x 2 3/4 HEX HD. CAP SCREW | |
| 9. 3/8" INTERNAL TOOTH LOCKWASHER | |
| 10. BACK-UP LIGHT SWITCH BRACKET | Pt. 117 6889 |
| 11. ROD ADJUSTING BUTTON (3) | |
| 12. ALIGNMENT ROD | Pt. 148 1725 |
| 13. ARM - 1st/2nd | Pt. 105 2723 |
| 14. ROD - 1st/2nd | Pt. 213 1720 |
| 15. NYLON BUSHING | Pt. 118 1681 (6) |
| 16. SPRING CLIP | Pt. 97000015 (6) |
| 17. ARM - 3rd/4th | Pt. 105 2108 |
| 18. ROD - 3rd/4th | Pt. 213 2774 |
| 19. ARM - REVERSE | Pt. 105 2725 |
| 20. ROD - REVERSE | Pt. 213 3207 |
| 21. BAGGED HARDWARE | Pt. 154 3183 |

3735587

- | | |
|---------------------------|------------------|
| MOUNTING PLATE | Pt. 195 6834 |
| NOT USED | |
| NOT USED | |
| 7/16 - 20 x 3 H.H.C.S. | |
| 3/8 - 24 x 2 3/4 H.H.C.S. | |
| | Pt. 117 6889 |
| | Pt. 148 1725 |
| | Pt. 105 2723 |
| | Pt. 213 1720 |
| | Pt. 118 1681 (6) |
| | Pt. 97000015 (6) |
| | Pt. 105 2108 |
| | Pt. 213 2774 |
| | Pt. 105 2725 |
| | Pt. 213 3207 |
| BAGGED HARDWARE | Pt. 154 4197 |

Should interference occur between the Reverse rod end and the 1-2 button in the shifter lever, you may have to cut off the end of the Reverse rod that extends beyond the button.

MOUNTING PLATES

373 3185

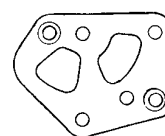

Pt. 195 3176

3735587

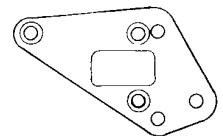

Pt. 195 6834